

82° Flat Head

Screw Size	Cruciform Wood Cut Thread	Cruciform Machine & Metal Punch Numbers	Cruciform Type A -Wood Rolled Thread	1A Punch Numbers
2	3P10-1	3P10-1	3P10-1	1A10-1
3	3P10-2	3P10-2	3P10-2	1A10-2
4	3P10-3	3P10-3	3P10-3	1A10-3
5	3P20-1	3P20-1	3P20-1	1A20-1
6	3P20-2	3P20-2	3P20-2	1A20-2
7		3P20-6	3P20-6	1A20-6
7	3P20-3			1A20-3
8		3P20-3	3P20-3	1A20-3
8	3P20-4			1A20-4
9	3P20-5			1A20-5
10		3P20-4	3P20-4	1A20-4
10	3P30-1			1A30-1
12		3P30-2	3P30-2	1A30-2
12	3P30-3			1A30-3
14			3P30-3	1A30-3
14	3P30-4			1A30-4
1/4		3P30-3		1A30-3
16			3P30-4	1A30-4
16	3P30-5			1A30-5
18			3P40-4	1A40-4
18	3P40-1			1A40-1
5/16		3P40-4		1A40-4
3/8		3P40-2		1A40-2
20			3P40-1	1A40-1
20	3P40-2			1A40-2
7/16		3P40-5		1A40-5
24			3P40-2	1A40-2
24	3P40-3			1A40-3
1/2		3P40-3		1A40-3

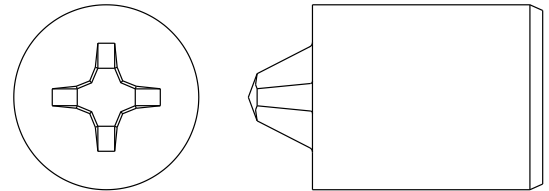

100° Flat Head

Screw Size	Cruciform Punch Number	1A Punch Numbers
2	3P10-80	1A10-80
3	3P10-1	1A10-1
4	3P10-54	1A10-54
5	3P20-123	1A20-123
6	3P20-1	1A20-1
7	3P20-1	1A20-1
8	3P30-135	1A20-135
9	3P20-2	1A20-2
10	3P20-136	1A20-136
12	3P30-46	
14	3P30-93	1A30-93
1/4	3P30-93	1A30-93
16	3P30-2	1A30-2
18	3P30-3	1A30-3
5/16	3P40-79	1A40-79
3/8	3P40-106	1A40-106

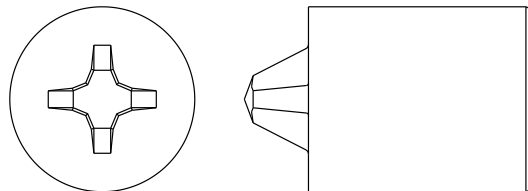

1. Punch materials:

- M2 at RC 62-64
- M42 at RC 63-65

2. Punches available with headmarking and company logo. Please specify when ordering.

3. PVD Coatings available for cold & hot heading applications.

82° Oval Head

Screw Size	Cruciform Wood Cut Thread	Cruciform Machine & Metal Punch Numbers	Cruciform Type A - Wood Rolled Thread	1A Punch Numbers
2	3P10-4	3P10-4	3P10-4	1A10-4
3	3P10-5	3P10-5	3P10-5	1A10-5
4	3P10-6	3P10-6	3P10-6	1A10-6
5	3P20-7	3P20-7	3P20-7	1A20-7
6	3P20-8	3P20-8	3P20-8	1A20-8
7	3P20-9			1A20-9
7		3P20-14	3P20-14	1A20-14
8	3P20-10			1A20-10
8		3P20-12	3P20-12	1A20-12
9	3P20-11			1A20-11
10	3P30-6			1A30-6
10		3P20-13	3P20-13	1A20-13
12	3P30-8			1A30-8
12		3P30-11	3P30-11	1A30-11
14	3P30-9			1A30-9
14			3P30-13	1A30-13
1/4		3P30-12		1A30-12
16	3P30-10		3P30-10	1A30-10
18	3P40-6		3P40-6	1A40-6
5/16		3P40-13		1A40-13

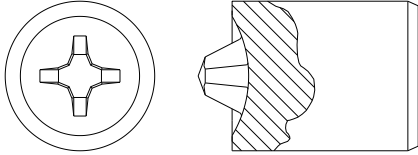

100° Oval Head

Screw Size	Cruciform Punch Number	1A Punch Numbers
2	3P10-82	1A10-82
3	3P10-83	1A10-83
4	3P10-84	1A10-84
5	3P20-7	1A20-7
6	3P20-8	1A20-8
7	3P20-14	1A20-14
8	3P20-12	1A20-12
9	3P20-203	1A20-203
10	3P20-13	1A20-13
12	3P30-11	1A30-11
14	3P30-13	1A30-13
1/4	3P30-12	1A30-12
16	3P30-142	1A30-142
18	3P40-6	1A40-6
5/16	3P40-13	1A40-13
3/8	3P40-10	1A40-10

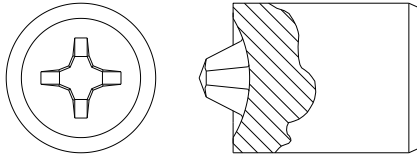

1. Punch materials:

- M2 at RC 62-64
- M42 at RC 63-65

2. Punches available with headmarking and company logo. Please specify when ordering.

3. PVD Coatings available for cold & hot heading applications.

Round Head

Screw Size	Cruciform Machine & Tapping Punch	Cruciform Wood Cut Thread	1A Punch Numbers
2	3P10-46	3P10-9	
3	3P10-45	3P10-10	
4		3P10-11	
4	3P10-44		1A10-44
5	3P20-30		1A20-30
6	3P20-15	3P20-15	1A20-15
7	3P20-16	3P20-16	1A20-16
8	3P20-17	3P20-17	1A20-17
9		3P20-18	
10	3P20-19	3P20-19	1A20-19
12	3P30-16	3P30-16	1A30-16
14	3P30-17	3P30-17	1A30-17
1/4	3P30-19		1A30-19
16	3P30-18	3P30-18	1A30-18
18	3P40-110	3P40-14	
5/16	3P30-20		1A30-20
20	3P40-111	3P40-15	
24	3P40-16	3P40-16	
3/8	3P40-16		
7/16	3P40-17		
1/2	3P40-18		

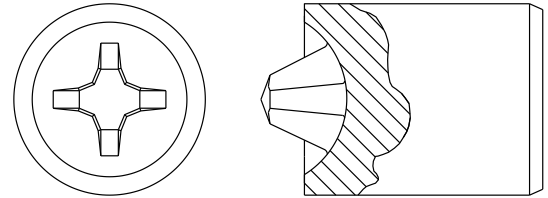

Combination/Slotted Round Head

Screw Size	Cruciform Punch Number
2	3P10-129
3	3P10-130
4	3P10-131
5	3P20-475
6	3P20-389
7	3P20-476
8	3P20-390
10	3P20-391
12	3P30-207
1/4	3P30-208
5/16	3P30-209

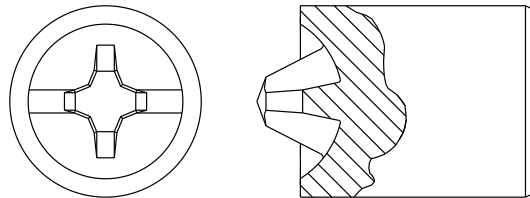

1. Punch materials:

- M2 at RC 62-64
- M42 at RC 63-65

2. Punches available with headmarking and company logo. Please specify when ordering.

3. PVD Coatings available for cold & hot heading applications.

Pan Head

Screw Size	Cruciform Punch Number	1A Punch Numbers
2	3P10-13	1A 10-13
3	3P10-14	1A 10-14
4	3P10-15	1A 10-15
5	3P20-20	1A 20-20
6	3P20-21	1A 20-21
7	3P20-22	1A 20-22
8	3P20-23	1A 20-23
10	3P20-25	1A 20-25
12	3P30-21	1A 30-21
14	3P30-226	3P30-226
1/4	3P30-22	1A 30-22
16	3P30-185	1A 30-185
18	3P40-201	1A 40-201
5/16	3P40-9	1A 40-9
20	3P40-9	1A 40-9
24	3P40-26	1A 40-26
3/8	3P40-26	1A 40-26
7/16	3P40-27	1A 40-27
1/2	3P40-28	1A 40-28

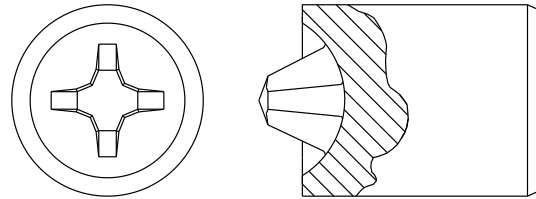

Combination/Slotted Pan Head

Screw Size	Cruciform Punch Number	1A Punch Numbers
2	3P10-154	1A 10-154
3	3P10-155	1A 10-155
4	3P10-156	1A 10-156
5	3P20-551	1A 20-551
6	3P20-552	1A 20-552
7	3P20-553	1A 20-553
8	3P20-554	1A 20-554
10	3P20-555	1A 20-555
12	3P30-236	1A 30-236
1/4	3P30-237	1A 30-237
5/16	3P40-267	1A 40-267

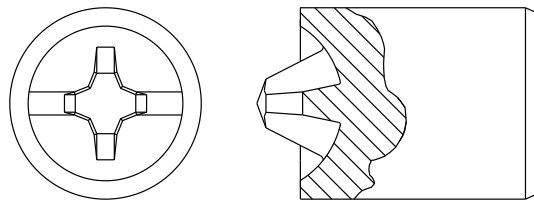

1. Punch materials:

- M2 at RC 62-64
- M42 at RC 63-65

2. Punches available with headmarking and company logo. Please specify when ordering.

3. PVD Coatings available for cold & hot heading applications.

Fillister Head

Screw Size	Machine & Tapping Finished Head	Machine & Tapping Shaved Head	1A Punch Numbers
2	3P10-35		1A10-35
2		3P10-13	1A10-13
3	3P10-37		1A10-37
3		3P10-14	1A10-14
4	3P10-36		1A10-36
4		3P10-15	1A10-15
5	3P20-265		1A20-265
5		3P20-346	1A20-346
6	3P20-257		1A20-257
6		3P20-21	1A20-21
7	3P20-278		1A20-278
7		3P20-22	1A20-22
8	3P20-266		1A20-266
8		3P20-23	1A20-23
10	3P20-258		1A20-258
10		3P20-25	1A20-25
12	3P30-68		1A30-68
12		3P30-21	1A30-21
14	3P30-67		1A30-67
14		3P30-22	1A30-22
1/4	3P30-67		1A30-67
1/4		3P30-22	1A30-22
5/16	3P30-69		1A30-69
5/16		3P30-140	1A30-140
3/8	3P40-162		1A40-162
3/8		3P40-26	1A40-26
7/16	3P40-163		1A40-163
7/16		3P40-27	1A40-27
1/2	3P40-164		1A40-164
1/2		3P40-28	1A40-28

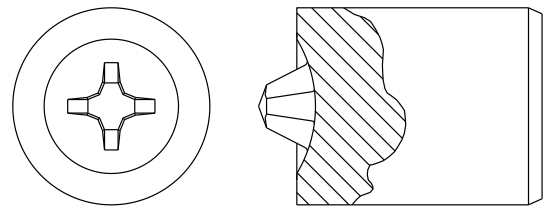

Binding Head

Screw Size	Cruciform Punch Number	1A Punch Numbers
2	3P10-63	1A10-63
3	3P10-64	1A10-64
4	3P10-62	1A10-62
5	3P20-144	1A20-144
6	3P20-133	1A20-133
8	3P20-145	1A20-145
10	3P20-143	1A20-143
12	3P30-96	1A30-96
1/4	3P30-97	1A30-97
5/16	3P40-107	1A40-107
3/8	3P40-108	1A40-108

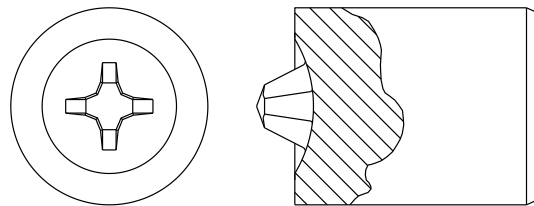

1. Punch materials:

- M2 at RC 62-64
- M42 at RC 63-65

2. Punches available with headmarking and company logo. Please specify when ordering.

3. PVD Coatings available for cold & hot heading applications.

Washer Head

Screw Size	Cruciform Punch Number	1A Punch Numbers
2	3P10-23	
3	3P10-24	
4	3P10-25	1A10-25
5	3P20-45	1A20-45
6	3P20-46	1A20-46
7	3P20-47	1A20-47
8	3P20-48	1A20-48
10	3P20-49	1A20-49
12	3P30-42	1A30-42
1/4	3P30-43	1A30-43
5/16	3P30-44	1A30-44
3/8	3P40-36	1A40-36
7/16	3P40-37	1A40-37
1/2	3P40-38	1A40-38

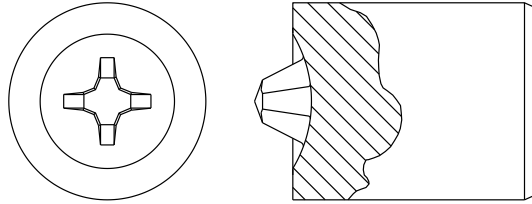

Indented Hexagon Head

Screw Size	Cruciform Punch Number	1A Punch Numbers
2	310P-127	
3	3P10-128	
4	3P10-41	1A10-41
5	3P10-42	1A10-42
6	3P20-100	1A20-100
7	3P20-100	1A20-100
8	3P20-102	1A20-102
10	3P20-103	1A20-103
12	3P30-59	1A30-59
1/4	3P30-71	1A30-71
1/4	3P30-87	1A30-87
5/16	3P40-242	1A40-242
3/8	3P40-243	1A40-243

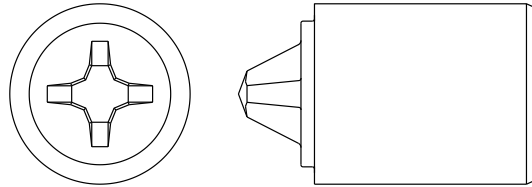

Trimmed Hexagon Head

Screw Size	Cruciform Punch Number	1A Punch Numbers
4	3P10-157	1A10-157
6	3P20-137	1A20-137
8	3P20-474	1A20-474
10	3P20-147	1A20-147
12	3P30-94	1A30-94
1/4	3P30-58	1A30-58
5/16	3P40-65	1A40-65
3/8	3P40-66	1A40-66
7/16	3P40-67	1A40-67
1/2	3P40-68	1A40-68

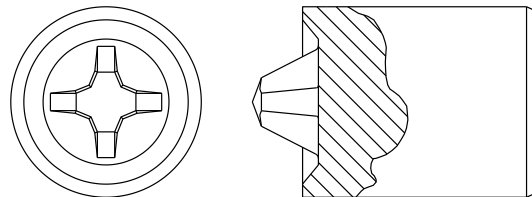

1. Punch materials:

- M2 at RC 62-64
- M42 at RC 63-65

2. Punches available with headmarking and company logo. Please specify when ordering.

3. PVD Coatings available for cold & hot heading applications.

Flat Top Truss Head

Screw Size	Cruciform Punch Number	1A Punch Numbers
2	3P10-100	1A10-100
3	3P10-101	1A10-101
4	3P10-102	1A10-102
5	3P10-103	1A10-103
6 (9/16)	3P20-321	1A20-321
6 (7/16)	3P20-338	1A20-338
7	3P20-322	1A20-322
8	3P20-323	1A20-323
10 (7/8)	3P20-324	1A20-324
10 (3/4)	3P20-339	1A20-339
12	3P30-167	1A30-167
14 (7/8)	3P30-227	1A30-227
14 (1)	3P30-228	1A30-228
1/4 (7/8)	3P30-168	1A30-168
1/4 (1)	3P30-180	1A30-180
16	3P30-184	1A30-184
18	3P40-199	1A40-199
5/16 (1)	3P40-172	1A40-172
5/16 (1-1/4)	3P40-189	1A40-189
20	3P40-200	1A40-200
24	3P40-173	1A40-173
3/8	3P40-173	1A40-173
7/16	3P40-174	1A40-174
1/2	3P40-175	1A40-175

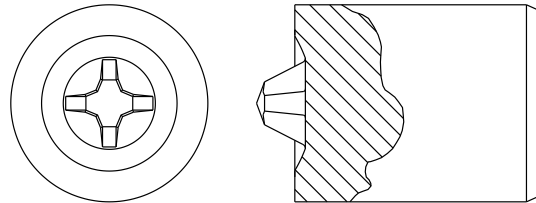

Full Contour Truss Head

Screw Size	Cruciform Punch Number
2	3P10-13
3	3P10-61
4	3P10-17
5	3P10-18
6 (9/16)	3P20-63
6 (7/16)	3P20-142
8	3P20-33
10 (7/8)	3P20-34
10 (3/4)	3P20-153
12	3P30-24
1/4 (7/8)	3P30-25
14 (1)	3P30-115
5/16 (1)	3P40-20
5/16 (1-1/4)	3P40-94
3/8 (1-1/2)	3P40-105
3/8 (1-1/4)	3P40-21
7/16	3P40-22
1/2	3P40-31

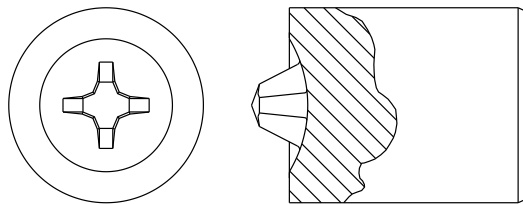

1. Punch materials:

- M2 at RC 62-64
- M42 at RC 63-65

2. Punches available with headmarking and company logo. Please specify when ordering.

3. PVD Coatings available for cold & hot heading applications.